

MAV 2008

MAV 2108

MAV 2208

Standard Series

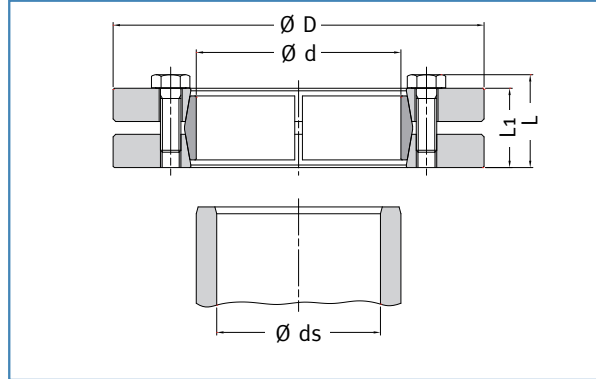

Example of order: MAV 2008 68 x 115

Composition

- Slotted inner ring
- Front outer ring
- Rear outer ring
- Set of hexagonal head cap screws, grade 10.9 (size <math>< \text{M6}</math> of grade 8.8)

Features

- External locking device for hollow shaft (hub) - shaft connection
- Three-part design
- Self-releasing tapers, greased with MoS₂ ($\mu = 0.05$)
- Screws greased with MoS₂ ($\mu = 0.10$)
- Zinc plated outer rings
- O-Ring between outer rings from size $d = 140$ mm and above
- MAV 2008: standard series, medium capacity
- MAV 2108: light series, low capacity
- MAV 2208: heavy series, high capacity
- SPLIT and HALF HC and HT versions also available (for HALF versions, performances are reduced of 50%)
- Tolerances of shaft and hub bore: see table
- Tolerance of hub outer diameter: h8
- Surface finish of shaft and hub $Ra < 3.2 \mu\text{m}$
- Shaft - hub bore contact surface grease-free and dry ($\mu = 0.15$)

Shaft Diameter ds		ISO Tollerances	Max Clearance
from	to		mm
6	10	H6 - j6	0,011
11	18		0,014
19	30		0,017
31	50	H6 - h6	0,032
51	80	H6 - g6	0,048
81	120	H7 - g6	0,069
121	180		0,079
181	250		0,09
251	315		0,101
316	400		0,111
401	500		0,123

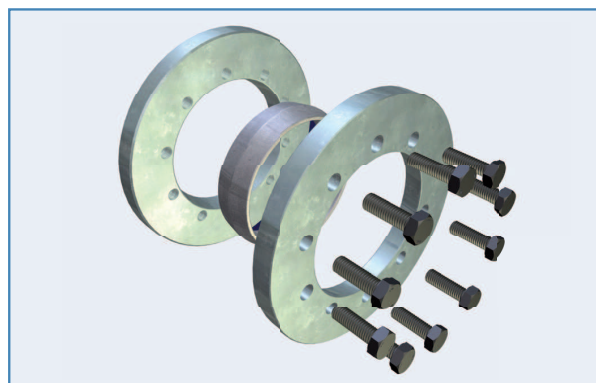

MAV 2108

Light Series

DIMENSIONS										SCREWS			FEATURES				WEIGHT kg
ds mm	d mm	x	D mm	L mm	L1 mm	L2 mm	L3 mm	lv mm	a x 45° mm	n.	size	Ma Nm	Mt Nm	Fax kN	Ps MPa	Ph MPa	
95	125	x	190	58,4	52,0	22,0	31,0	158	4,0	8	M 10	59	11.000	230	130	184	5,6
100													13.200	260	140	184	
105													15.600	300	150	184	
110	140	x	220	58,4	52,0	22,0	31,0	175	4,0	10	M 10	59	18.600	340	163	206	7,9
120													24.200	400	179	206	
125													27.000	430	183	206	
130	155	x	245	58,4	52,0	22,0	31,0	192	4,0	12	M 10	59	30.500	470	192	223	9,9
135													34.100	500	198	223	
140													37.800	540	205	223	
135	165	x	260	69,5	62,0	26,0	36,0	210	5,5	10	M 12	100	36.800	550	186	220	13
140													40.900	580	193	220	
145													45.200	620	198	220	
145	175	x	275	69,5	62,0	26,0	36,0	220	5,5	10	M 12	100	40.500	560	178	207	15
150													44.700	600	183	207	
155													49.000	630	188	207	
155	185	x	295	69,5	62,0	26,0	36,0	225	5,5	12	M 12	100	54.400	700	209	235	17
160													59.300	740	214	235	
165													64.500	780	218	235	
165	195	x	315	79,5	72,0	31,0	41,0	237	5,5	15	M 12	100	73.900	900	206	229	24
170													80.100	940	210	229	
175													86.500	990	214	229	
180	220	x	345	94,0	84,0	36,0	47,0	265	5,5	10	M 16	250	98.600	1.100	196	221	32
190													113.000	1.200	200	221	
200													129.000	1.300	208	221	
200	240	x	370	94,0	84,0	36,0	49,5	290	8,0	12	M 16	250	137.000	1.400	220	243	36
210													155.000	1.500	226	243	
215													165.000	1.500	229	243	
220	260	x	395	102,0	92,0	40,0	53,5	310	8,0	12	M 16	250	152.000	1.400	180	200	44
230													171.000	1.500	186	200	
235													181.000	1.500	188	200	
230	280	x	425	114,0	104,0	46,0	59,5	333	8,0	16	M 16	250	206.000	1.800	197	218	58
240													229.000	1.900	201	218	
250													255.000	2.000	206	218	
250	300	x	460	114,0	104,0	46,0	59,5	358	8,0	18	M 16	250	260.000	2.100	210	229	69
260													285.000	2.200	213	229	
270													313.000	2.300	217	229	
270	320	x	495	116,0	106,0	48,0	60,5	378	8,0	18	M 16	250	284.000	2.100	197	215	85
280													311.000	2.200	201	215	
290													340.000	2.300	204	215	
290	340	x	535	116,0	106,0	48,0	60,5	402	8,0	20	M 16	250	347.000	2.400	209	225	101
300													378.000	2.500	212	225	
310													410.000	2.600	215	225	
310	360	x	555	134,5	122,0	54,0	71,0	423	9,0	16	M 20	490	473.000	3.100	209	223	120
320													509.000	3.200	211	223	
330													549.000	3.300	214	223	
330	380	x	585	148,5	136,0	60,0	78,0	442	9,0	18	M 20	490	570.000	3.500	198	212	148
340													614.000	3.600	201	212	
350													660.000	3.800	204	212	
350	390	x	595	148,5	136,0	60,0	78,0	452	9,0	20	M 20	490	710.000	4.100	220	230	151
360													760.000	4.200	222	230	
370													812.000	4.400	225	230	
370	420	x	630	156,5	144,0	64,0	82,0	485	9,0	20	M 20	490	728.000	3.900	188	199	175
380													777.000	4.100	190	199	
390													828.000	4.200	193	199	
380	460	x	685	170,5	158,0	71,0	91,5	527	11,0	24	M 20	490	822.000	4.300	183	198	226
390													875.000	4.500	185	198	
410													982.000	4.800	188	198	
420	500	x	750	190,5	178,0	80,0	101,5	572	11,0	30	M 20	490	1.160.000	5.500	183	198	310
430													1.230.000	5.700	185	198	
440													1.300.000	5.900	187	198	

Code:

Ma: screws tightening torque

Ps: contact pressure on shaft

Mt: transmissible torque with Fax=0 kN

Ph: contact pressure on hub outer diameter

Fax: transmissible axial load with Mt=0 Nm