

MAV 3008    MAV 3108    MAV 3208  
 MAV 3009    MAV 3209

Standard Series

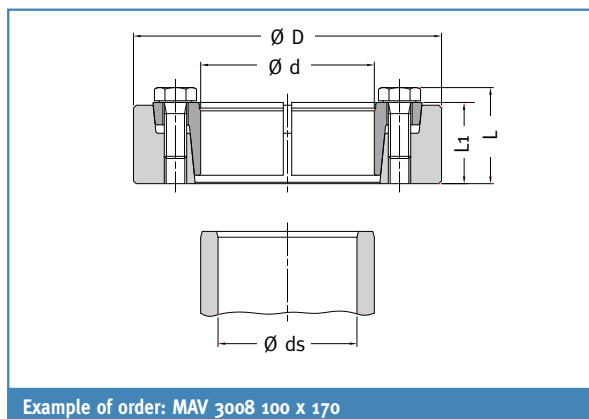
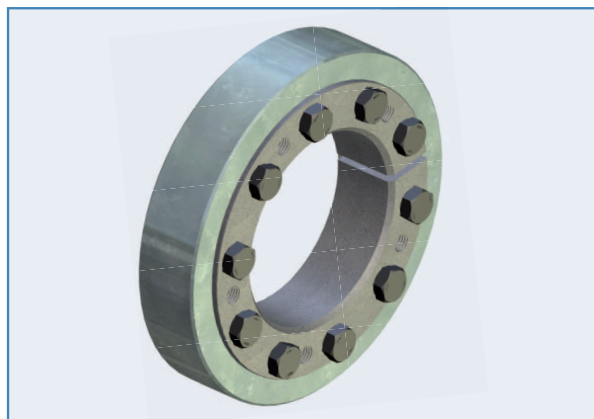

Example of order: MAV 3008 100 x 170

## Composition

- Slotted inner ring, with integrated push-off threads
- Outer ring
- Set of hexagonal head cap screws, grade 10.9 (size  $\lt M6$  of grade 8.8) for series MAV 3008 - MAV 3108 - MAV 3208; grade 12.9 for series MAV 3009 - MAV 3209
- Hardened washers DIN 6916 for units with screw size  $\geq M16$

## Features

- External locking device for hollow shaft (hub) - shaft connection
- Two-part design
- Self-releasing tapers, greased with MoS<sub>2</sub> ( $\mu = 0.05$ ). Series MAV 3008 – MAV 3009 feature oiled tapers (self-locking) up to size 68x115
- Screws greased with MoS<sub>2</sub> ( $\mu = 0.10$ )
- MAV 3008 – MAV 3009: standard series, medium capacity
- MAV 3108: light series, low capacity
- MAV 3208 – MAV 3209: heavy series, high capacity
- Tolerances of shaft and hub bore: see table
- Tolerance of hub outer diameter: h8
- Surface finish of shaft and hub  $Ra \lt 3.2 \mu m$
- Shaft – hub bore contact surface grease-free and dry ( $\mu = 0.15$ )

Shaft Diameter ds		ISO Tolerances	Max Clearance
from	to		mm
6	10	H6 - j6	0,011
11	18		0,014
19	30		0,017
31	50	H6 - h6	0,032
51	80	H6 - g6	0,048
81	120	H7 - g6	0,069
121	180		0,079
181	250		0,09
251	315		0,101
316	400		0,111
401	500		0,123

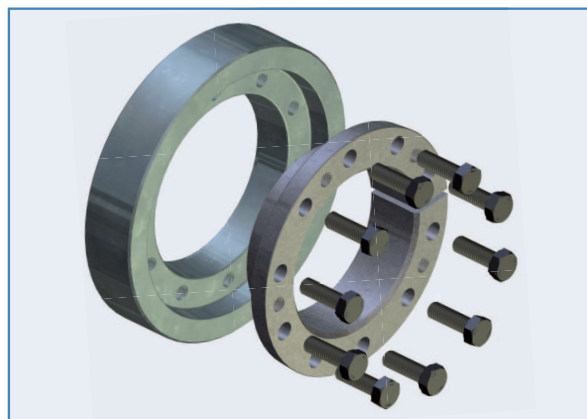

DIMENSIONS						SCREWS		FEATURES				WEIGHT kg
ds mm	d mm	x	D mm	L mm	L1 mm	size	Ma Nm	Mt Nm	Fax kN	Ps MPa	Ph MPa	
9	12	x	35	14,5	11	M 5	5	21	4,6	122	301	0,07
10								40	7,9	188	301	
11	14	x	38	14,5	11	M 5	5	29	5,3	114	258	0,08
12								51	8,4	167	258	
13	16	x	41	19	15	M 6	12	96	14	200	308	0,13
14								132	18	239	308	
15	18	x	44	19	15	M 6	12	121	16	190	274	0,14
16								159	19	220	274	
17	20	x	47	19	15	M 6	12	146	17	179	247	0,15
18								186	20	203	247	
19								172	18	145	235	0,20
20	24	x	50	22	18	M 6	12	218	21	165	235	
21								267	25	184	235	
24								297	24	137	205	
25	30	x	60	24	20	M 6	12	352	28	150	205	0,31
26								412	31	162	205	
28								563	40	169	234	0,49
30	36	x	72	27,3	22	M 8	30	714	47	187	234	
31								722	46	177	234	
34								734	43	135	215	
35	44	x	80	29,3	24	M 8	30	831	47	144	215	0,62
36								933	51	153	215	
38								1.230	65	166	241	0,83
40	50	x	90	31,3	26	M 8	30	1.490	74	180	241	
42								1.760	84	193	241	
42								1.640	78	172	240	
45	55	x	100	34,3	29	M 8	30	2.080	92	190	240	1,2
48								2.560	107	206	240	
48								1.940	81	156	213	1,4
50	62	x	110	34,3	29	M 8	30	2.230	89	165	213	
52								2.340	90	160	213	
50								1.810	72	134	218	
55	68	x	115	34,3	29	M 8	30	2.620	95	160	218	1,4
60								3.590	119	184	218	
55								2.770	100	156	233	2,3
60	75	x	138	37,4	31	M 10	59	3.760	125	178	233	
65								4.910	151	197	233	
60								3.200	106	151	218	
65	80	x	145	37,4	31	M 10	59	4.230	130	170	218	2,5
70								5.400	154	187	218	
65								4.730	145	159	226	3,4
70	90	x	155	44,4	38	M 10	59	6.030	172	174	226	
75								7.500	200	189	226	
70								6.440	184	164	231	
75	100	x	170	49,4	43	M 10	59	7.990	213	177	231	4,7
80								9.720	243	190	231	
75								8.810	234	170	236	6,2
80	110	x	185	56,5	49	M 12	100	10.600	267	182	236	
85								11.700	277	178	236	
80								11.200	280	177	236	
85	115	x	197	60,5	53	M 12	100	12.200	286	170	236	7,6
90								14.700	326	183	236	
85								11.000	259	154	226	7,3
90	120	x	197	60,5	53	M 12	100	13.300	296	166	226	
95								15.900	334	178	226	
85								11.600	274	163	241	
90	125	x	215	60,5	53	M 12	100	14.000	312	175	241	9,2
95								16.600	350	186	241	
85								10.600	250	149	232	8,8
90	130	x	215	60,5	53	M 12	100	12.800	286	161	232	
95								15.300	322	171	232	
90								13.000	289	148	224	
95	135	x	230	66,8	58	M 14	160	15.200	326	159	224	11
100								18.200	365	169	224	
95								14.300	301	146	216	11
100	140	x	230	66,8	58	M 14	160	16.800	337	156	216	
105								19.600	375	165	216	

# MAV 3008

## Standard Series

DIMENSIONS						SCREWS		FEATURES				WEIGHT kg
ds mm	d mm	x	D mm	L mm	L1 mm	size	Ma Nm	Mt Nm	Fax kN	Ps MPa	Ph MPa	
105								20.900	398	161	224	16
110	155	x	263	70,8	62	M 14	160	24.000	437	169	224	
115								27.400	477	176	224	
115								31.700	551	182	237	22
120	165	x	290	78	68	M 16	250	35.800	597	189	237	
125								39.100	626	190	237	
125								40.000	640	194	248	23
130	175	x	300	78	68	M 16	250	44.700	688	201	248	
135								49.700	737	207	248	
135								56.000	829	184	228	34
140	180	x	320	95	85	M 16	250	62.100	887	189	228	
145								68.500	945	195	228	
135								53.100	787	174	222	33
140	185	x	320	95	85	M 16	250	59.000	843	180	222	
145								65.200	899	185	222	
150								75.100	1.000	200	240	37
155	200	x	340	95	85	M 16	250	82.000	1.050	204	240	
160								89.300	1.110	209	240	
160								103.000	1.290	195	236	53
165	220	x	370	115,5	103	M 20	490	112.000	1.360	199	236	
170								121.000	1.430	203	236	
170								125.000	1.470	201	241	66
180	240	x	405	119,5	107	M 20	490	145.000	1.610	208	241	
190								164.000	1.730	211	241	
190								165.000	1.740	189	227	81
200	260	x	430	131,5	119	M 20	490	189.000	1.890	196	227	
210								215.000	2.050	202	227	
210								215.000	2.050	182	214	104
220	280	x	460	144,5	132	M 20	490	243.000	2.210	188	214	
230								273.000	2.370	193	214	
230								299.000	2.600	197	224	120
240	300	x	485	155	140	M 24	840	333.000	2.770	201	224	
250								369.000	2.950	205	224	
240								301.000	2.510	182	210	139
250	320	x	520	155	140	M 24	840	334.000	2.670	186	210	
260								365.000	2.800	188	210	
250								410.000	3.280	208	236	191
260	340	x	570	170	155	M 24	840	445.000	3.430	209	236	
270								489.000	3.630	213	236	
260								432.000	3.320	194	223	200
270	350	x	580	174	159	M 24	840	475.000	3.520	198	223	
280								520.000	3.710	201	223	
280								527.000	3.760	204	228	205
290	360	x	590	174	159	M 24	840	575.000	3.960	207	228	
300								625.000	4.160	211	228	
300								640.000	4.270	210	233	252
310	390	x	650	183	166	M 27	1250	693.000	4.470	213	233	
320								743.000	4.640	214	233	
330								809.000	4.900	192	214	288
340	420	x	670	203	186	M 27	1250	871.000	5.120	195	214	
350								935.000	5.340	198	214	
340								909.000	5.350	194	216	392
350	440	x	740	211	194	M 27	1250	976.000	5.580	197	216	
360								1.046.000	5.810	199	216	
360								1.035.000	5.750	197	217	423
370	460	x	770	211	194	M 27	1250	1.106.000	5.980	199	217	
380								1.179.000	6.210	202	217	
380								1.302.000	6.850	204	222	498
390	480	x	800	231,7	213	M 30	1700	1.386.000	7.100	206	222	
400								1.472.000	7.360	208	222	
400								1.391.000	6.950	196	213	575
410	500	x	850	231,7	213	M 30	1700	1.465.000	7.140	197	213	
420								1.553.000	7.390	199	213	

**Code:**

Ma: screws tightening torque

Mt: transmissible torque with Fax=0 kN

Fax: transmissible axial load with Mt=0 Nm

Ps: contact pressure on shaft

Ph: contact pressure on hub outer diameter